

FORM No. 1.

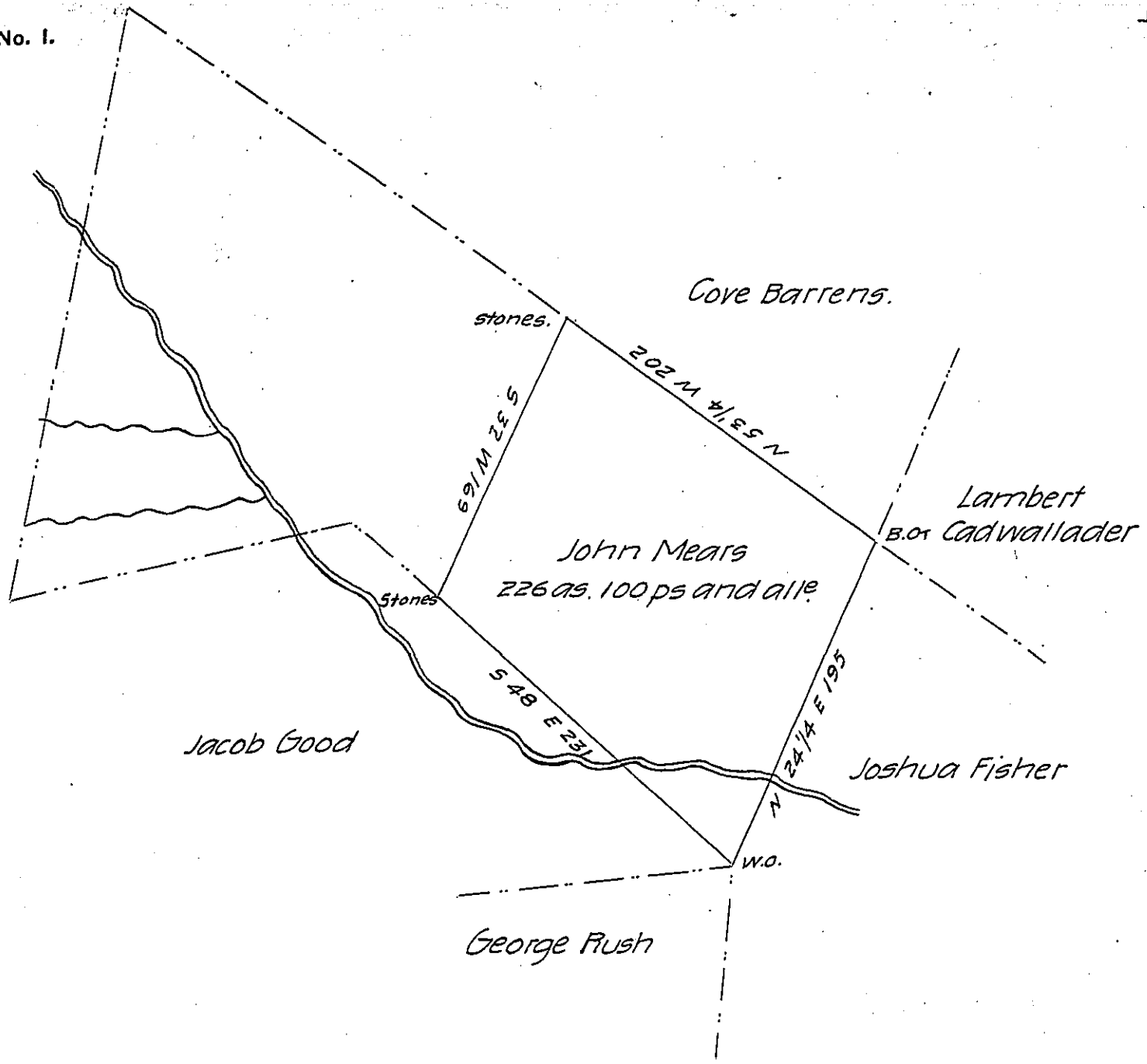

Situated in Morrisons Cove (now Bedford County) on the Beaver Dam branch of Yellowcreek, Containing 226 acres, 100 perches and allowance being part of a large survey containing 503 acres 67 perches & alle<sup>s</sup> surveyed to John Mears in pursuance of a Warrant dated the 25th day of October 1765

James Piper D.S.

Gabriel Hiester Esquire  
Surveyor General

IN TESTIMONY that the above is a copy of the original remaining on file in the Department of Internal Affairs of Pennsylvania, made conformably to an Act of Assembly approved the 16th day of February, 1833, I have hereunto set my Hand and caused the Seal of said Department to be affixed at Harrisburg, this twenty-second day of January 1906

*Leaac B. Brown*  
Secretary of Internal Affairs.